

# Outlet ▶ IPTV ▶ HDTV

- HDMI Cable (for high-clarity Video and Digital Surround Sound)



Ethernet Source  
(Router, Ethernet outlet)

IPTV Box

HDTV

With this configuration, the TV needs to be on its *HDMI INPUT CHANNEL* to receive the IPTV Box's HDMI signals.

VIDEO SOURCE

AUDIO SOURCE

IN

OPTICAL

SPDIF

AUDIO

R

L

COMPONENT VIDEO

Pb

Pr

CABLE/RF IN

OUT

HDMI 1

HDMI 2

HDMI 3

# Outlet ► Converter ► HDTV

- HDMI Cable (for high-clarity Video and Digital Surround Sound)

Cable Outlet

HD (and/or DVR) Converter

HDTV

With this configuration, the TV needs to be on *its* **HDMI INPUT CHANNEL** to receive the converter's HDMI signals.



# Outlet ► Converter ► HDTV

- HDMI Cable (for high-clarity Video and Digital Surround Sound)

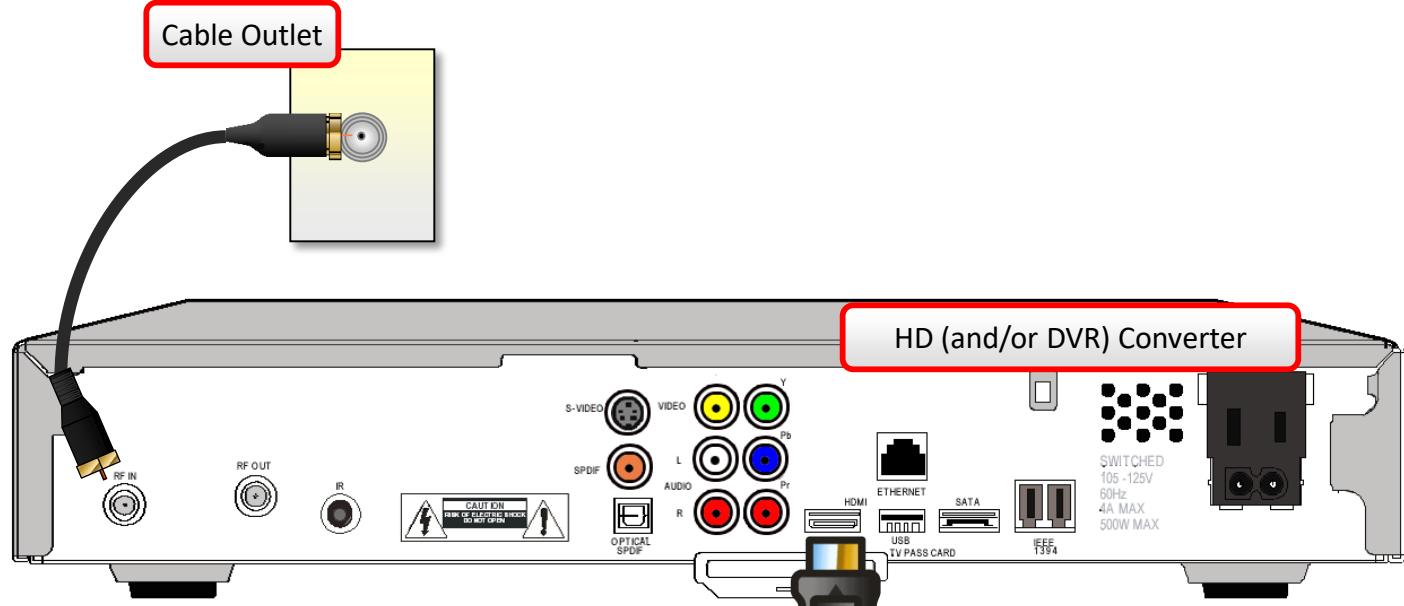

HDTV

With this configuration, the TV needs to be on *its* **HDMI INPUT CHANNEL** to receive the converter's HDMI signals.

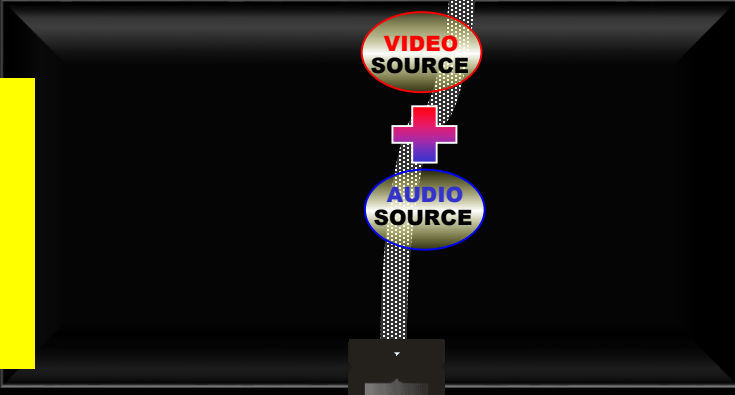

# Outlet ► Converter ► HDTV

- HDMI Cable (for high-clarity Video and Digital Surround Sound)

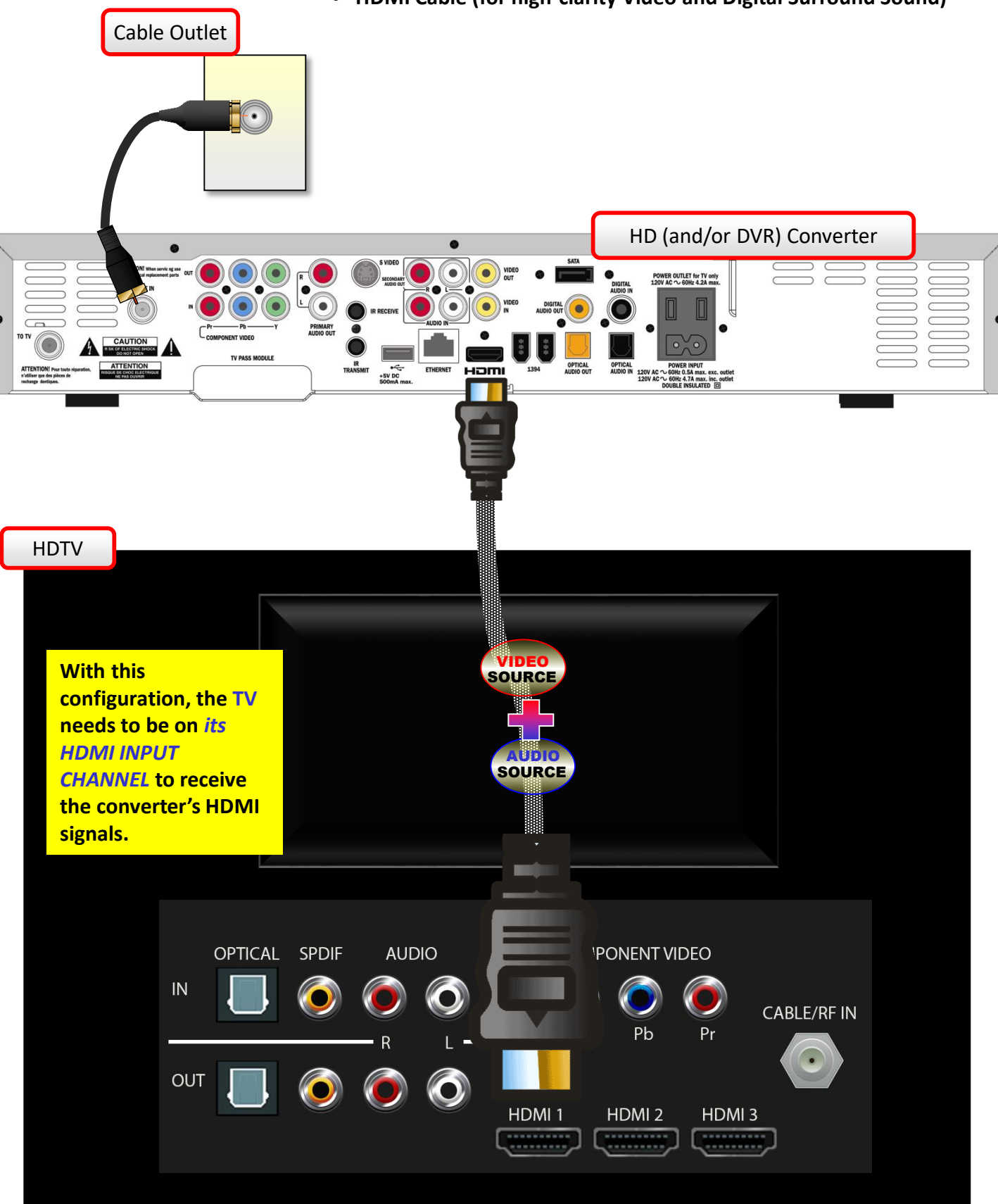

# Outlet ► eBox ► HDTV

- HDMI Cable (for high-clarity Video and Digital Surround Sound)

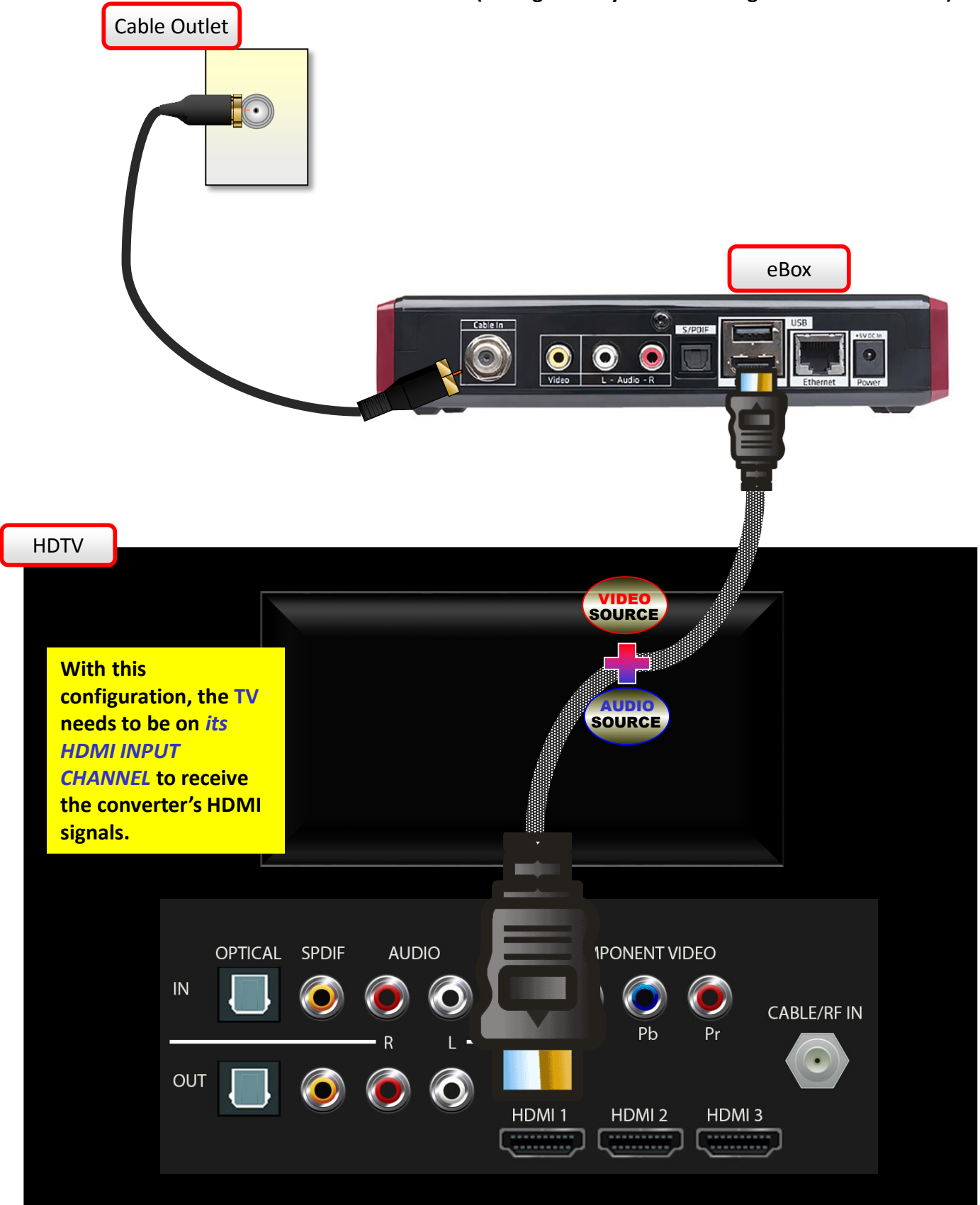

# Outlet ▶ Mini ▶ HDTV

- HDMI Cable (for high-clarity Video and Digital Surround Sound)

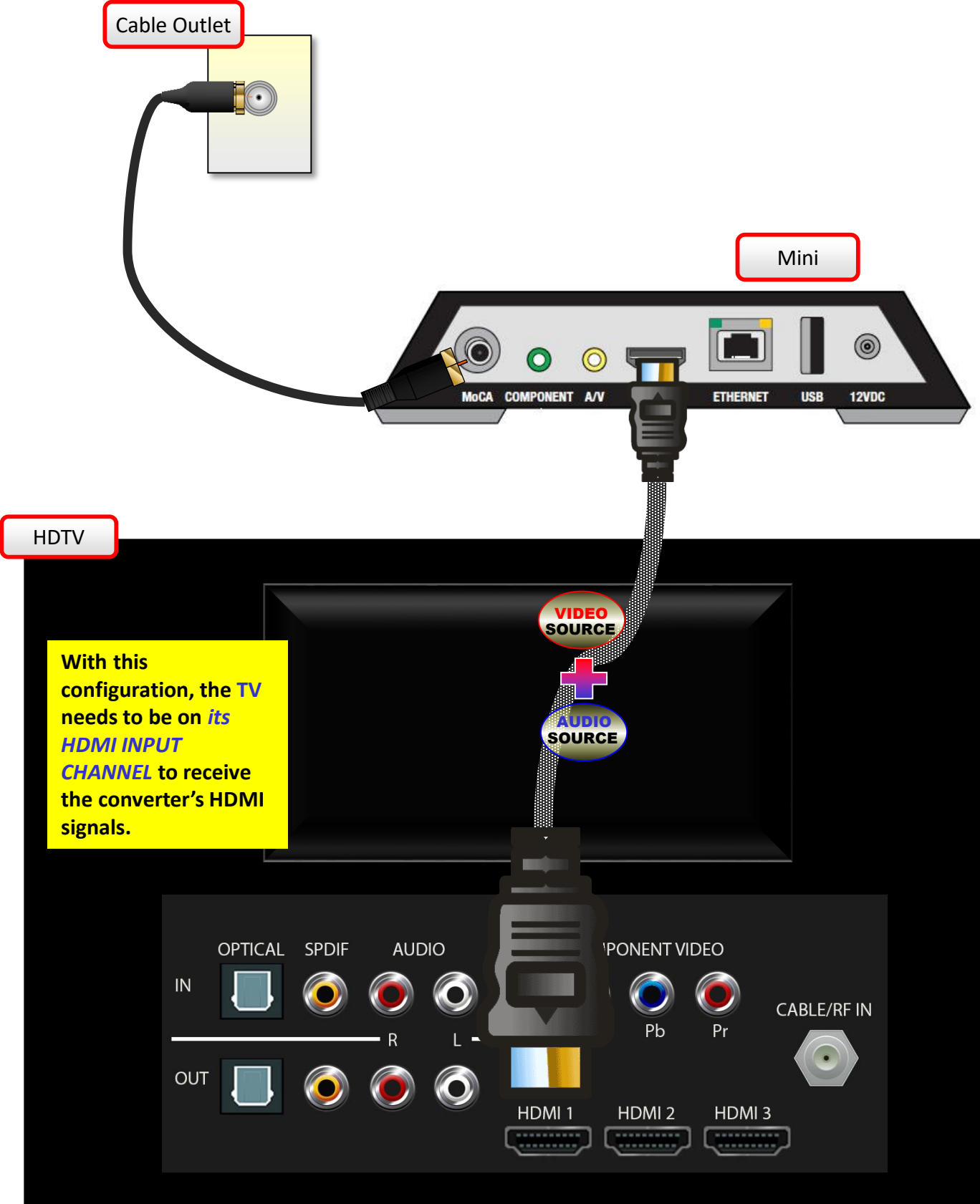

# Outlet ▶ Mini ▶ HDTV

- HDMI Cable (for high-clarity Video and Digital Surround Sound)

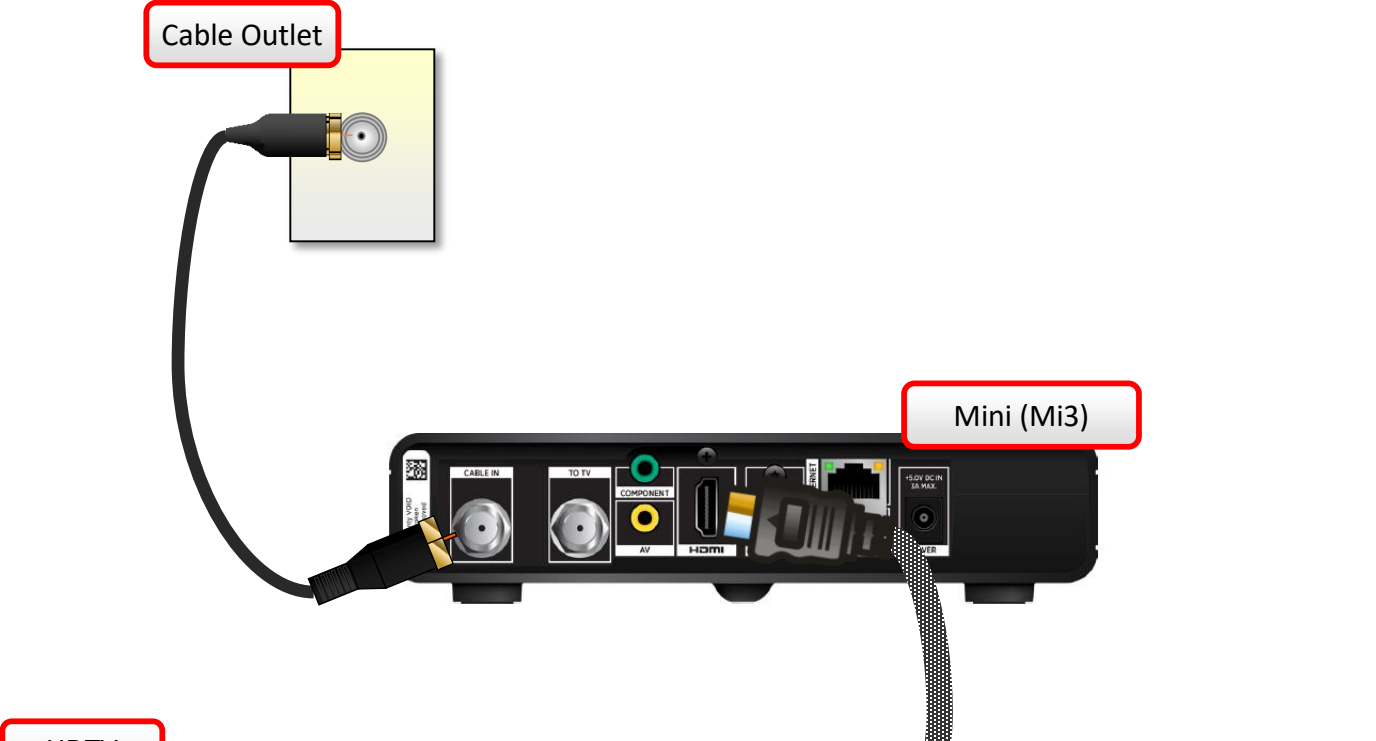

HDTV

With this configuration, the TV needs to be on *its* **HDMI INPUT CHANNEL** to receive the converter's HDMI signals.

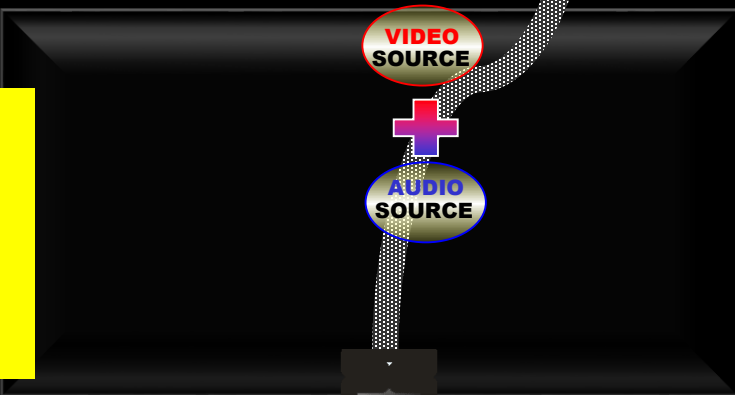

# Outlet ► HD DTA ► HDTV

- HDMI Cable (for high-clarity Video and Digital Surround Sound)

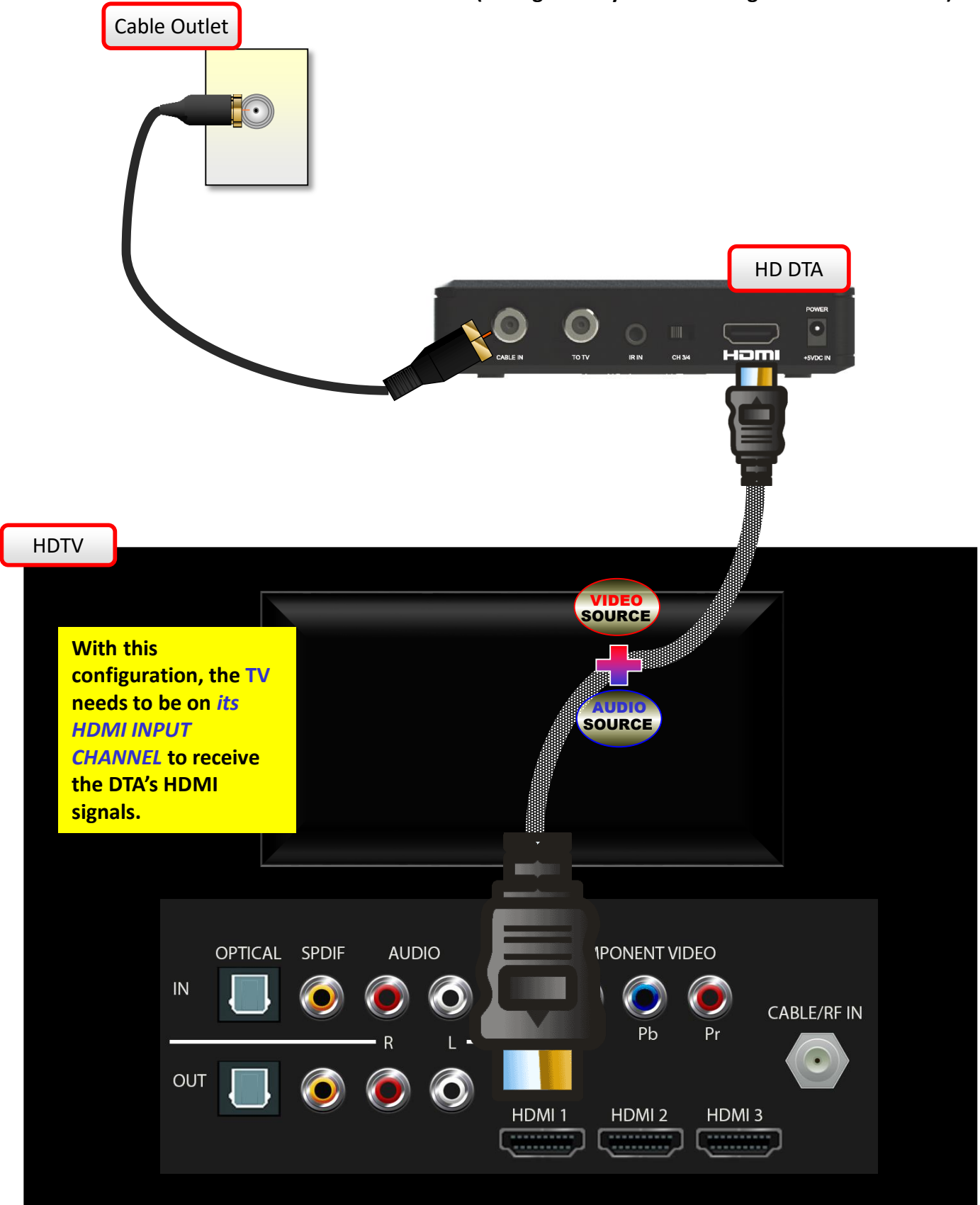



# Outlet ► HD DTA ► HDTV

- HDMI Cable (for high-clarity Video and Digital Surround Sound)

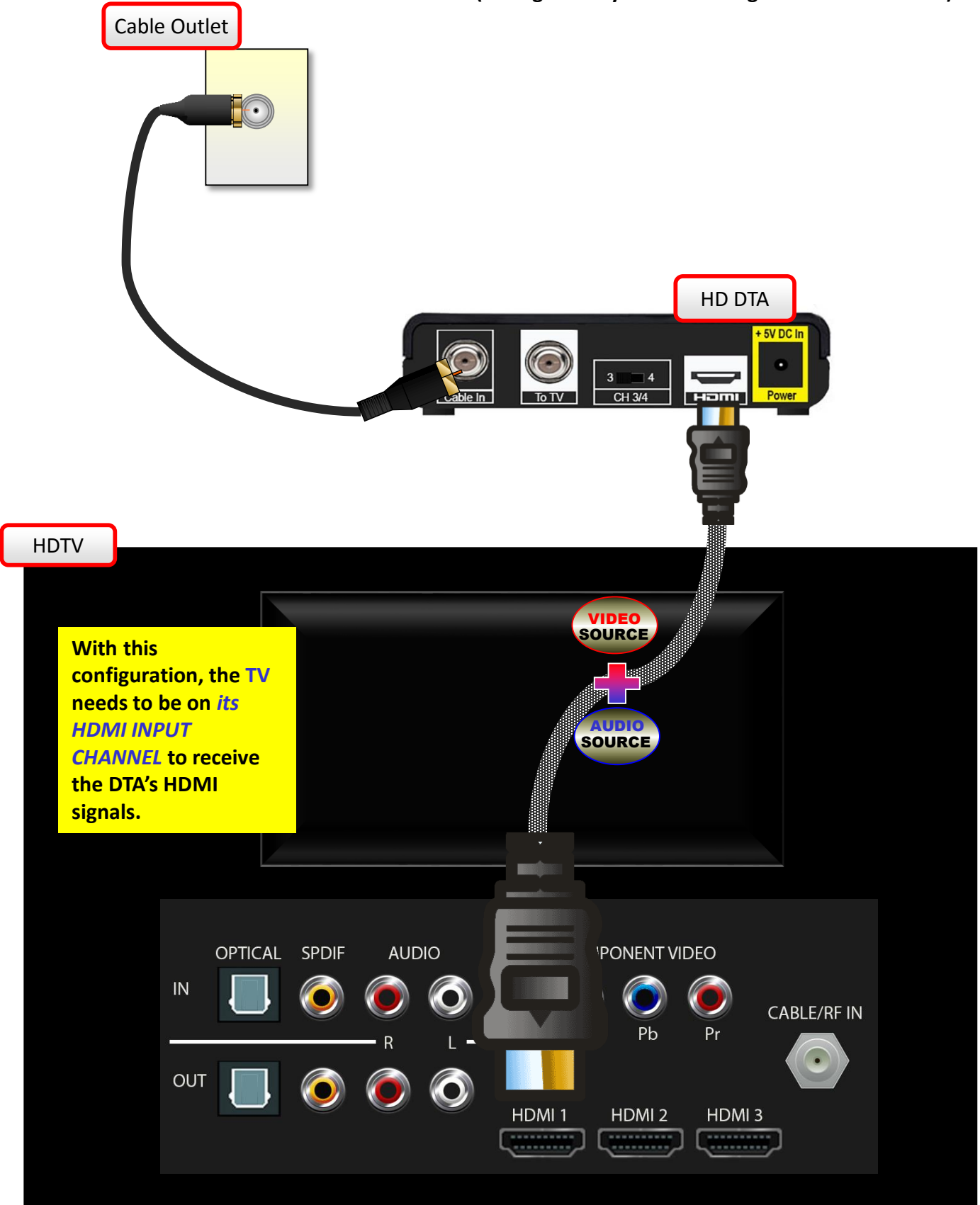

# Outlet ▶ IPTV ▶ HDTV

- HDMI Cable (for high-clarity Video and Digital Surround Sound)



Ethernet Source  
(Router, Ethernet outlet)

IPTV Box

HDTV

With this configuration, the TV needs to be on *its* **HDMI INPUT CHANNEL** to receive the IPTV Box's HDMI signals.

VIDEO SOURCE

AUDIO SOURCE

OPTICAL IN    SPDIF    AUDIO (R/L)    COMPONENT VIDEO (Pb/Pr)    CABLE/RF IN

OPTICAL OUT    SPDIF    AUDIO (R/L)    HDMI 1    HDMI 2    HDMI 3

# Outlet ► Converter ► HDTV

- DVI Cable (for high-clarity Video)
- Phono (L + R) stereo cables (RCA Type)

Cable Outlet

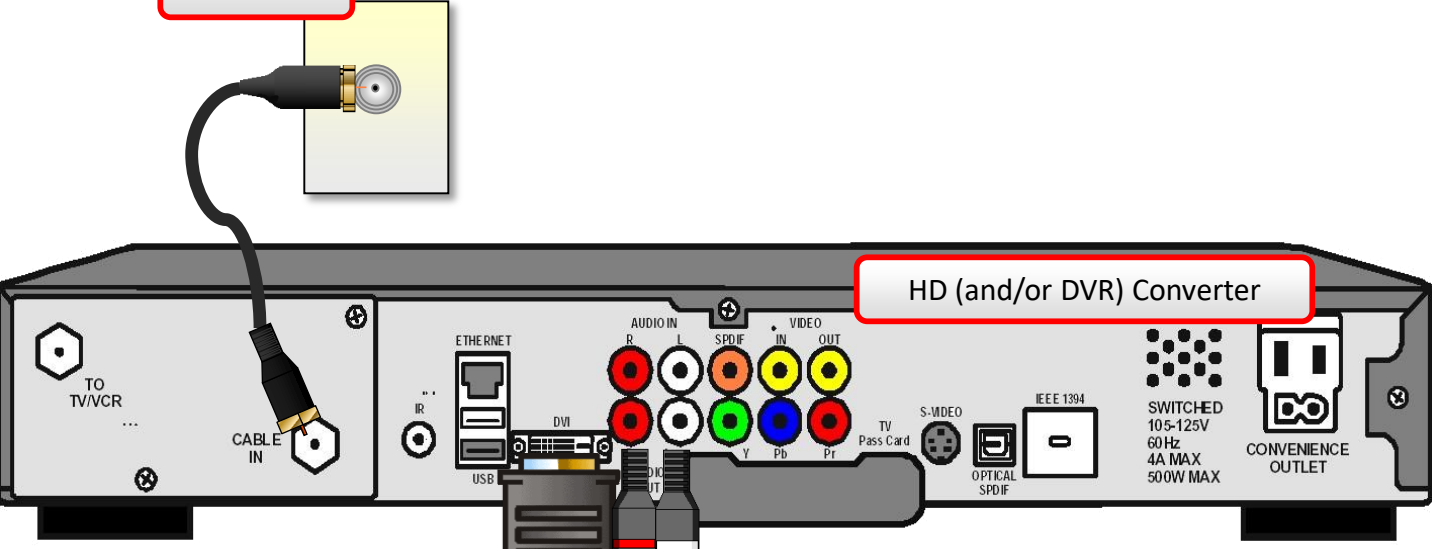

HD (and/or DVR) Converter

HDTV

With this configuration, the TV needs to be on *its DVI INPUT CHANNEL* to receive the converter's DVI signals.

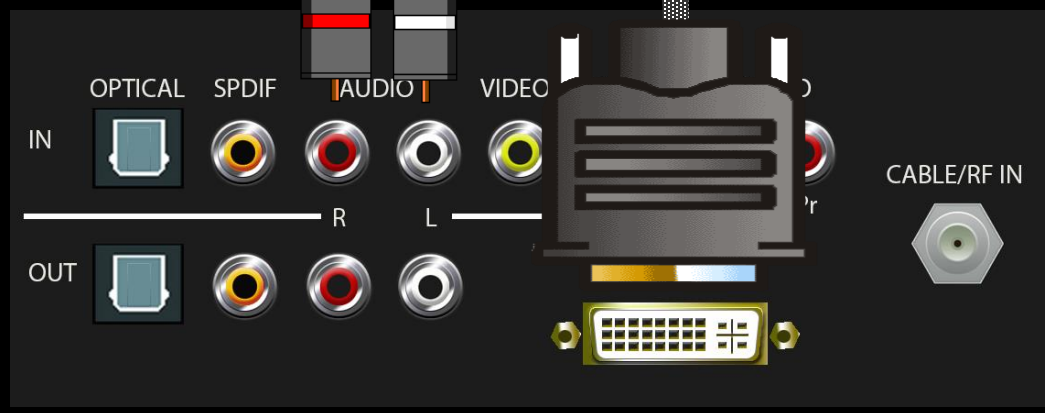
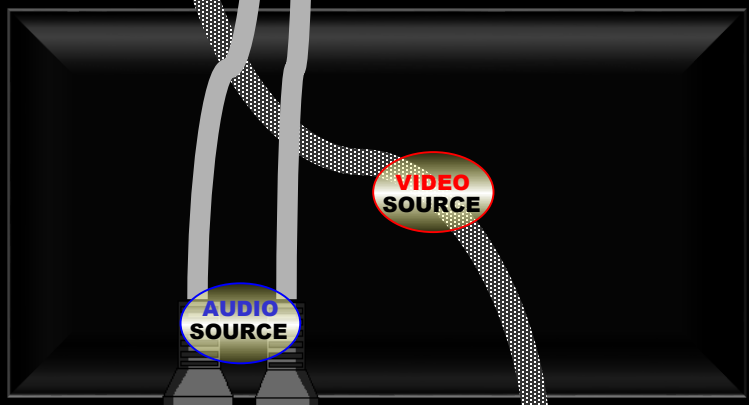

# Outlet ► Converter ► HDTV

- DVI Cable (for high-clarity Video)
- Coaxial SPDIF cable (for Surround Sound)

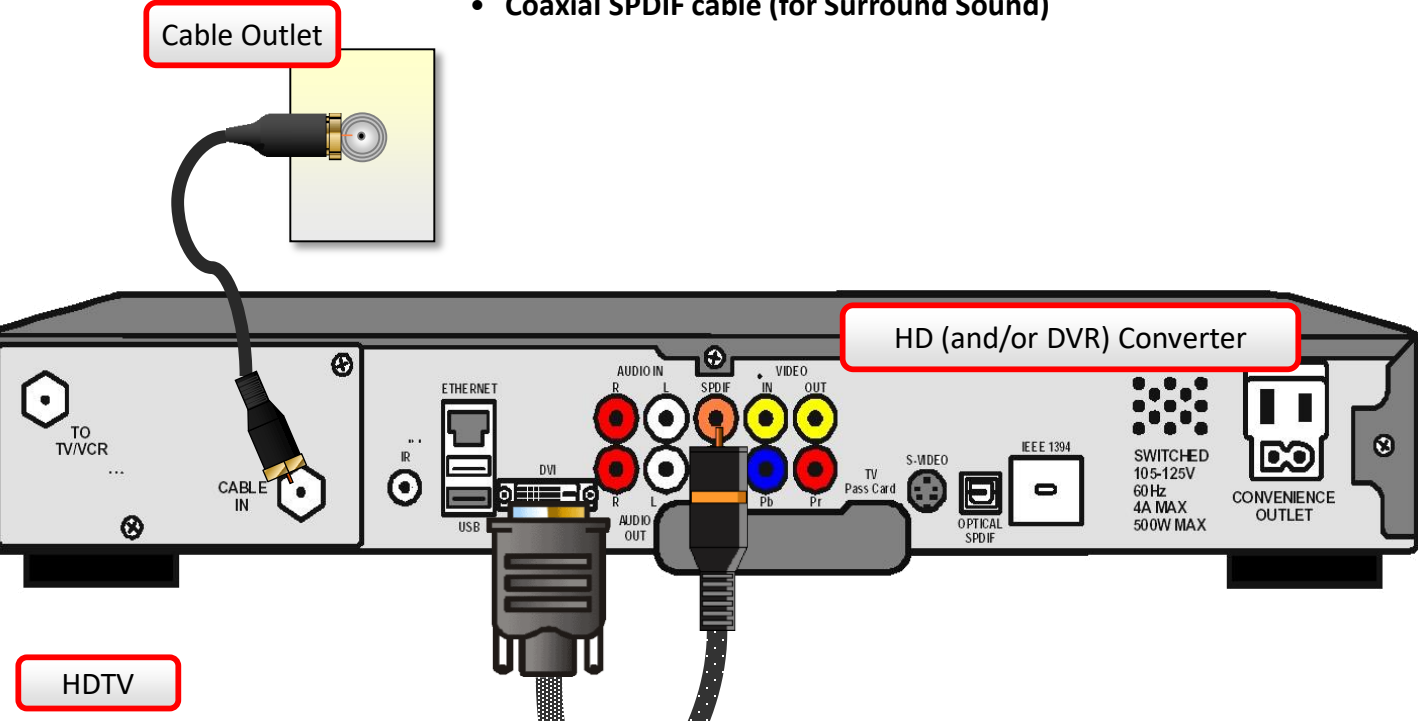

HDTV

With this configuration, the TV needs to be on *its DVI INPUT CHANNEL* to receive the converter's DVI signals.

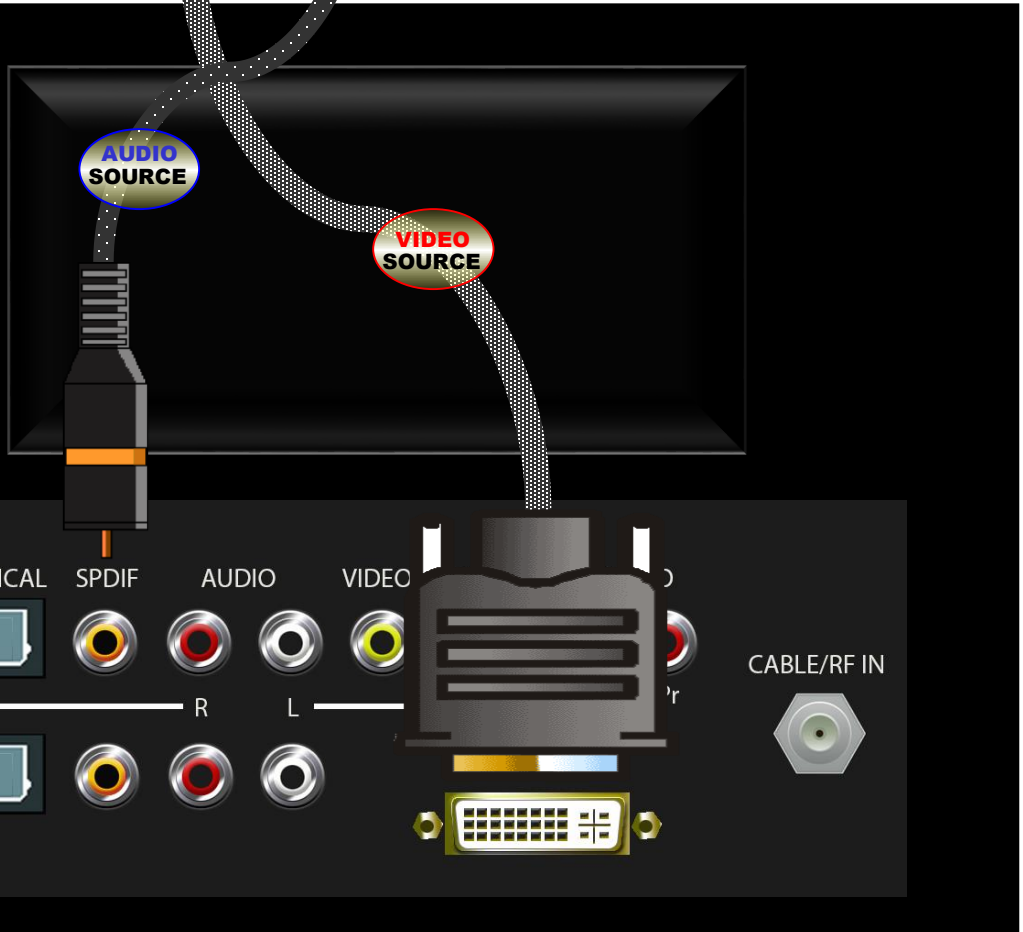

# Outlet ► Converter ► HDTV

- DVI Cable (for high-clarity Video)
- Optical SPDIF cable (for Digital Surround Sound)

Cable Outlet

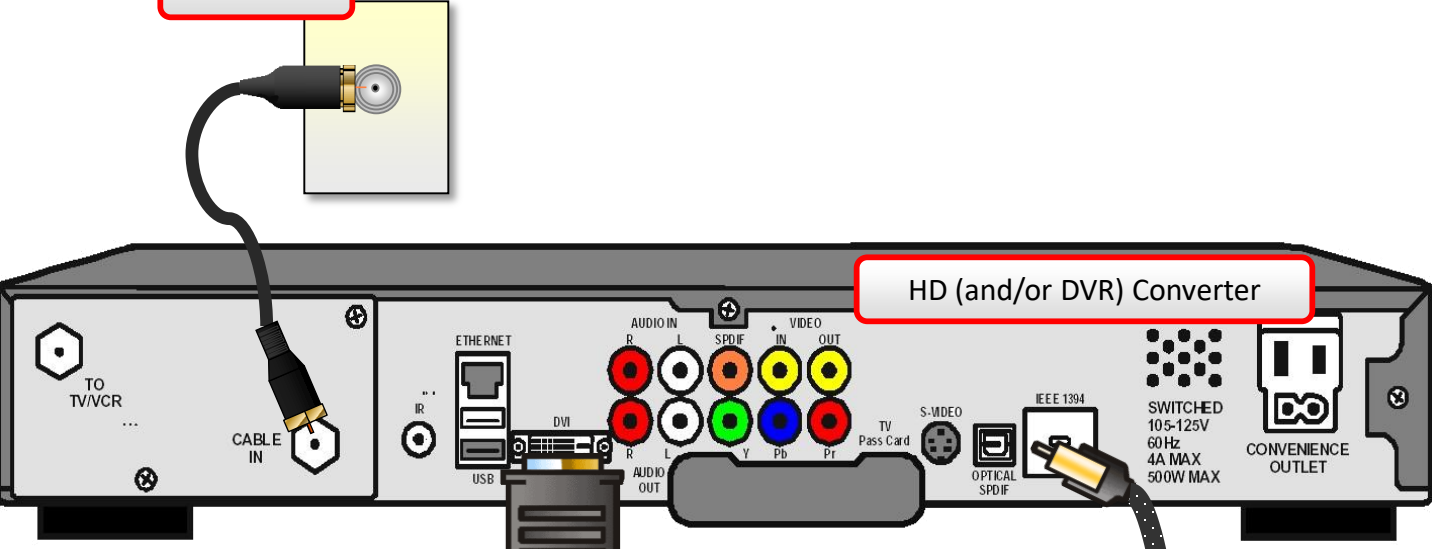

HD (and/or DVR) Converter

HDTV

With this configuration, the TV needs to be on *its DVI INPUT CHANNEL* to receive the converter's DVI signals.

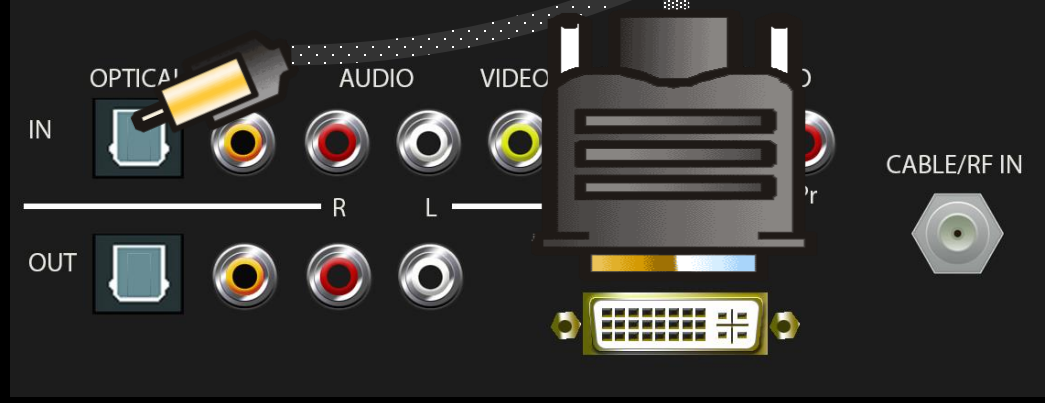
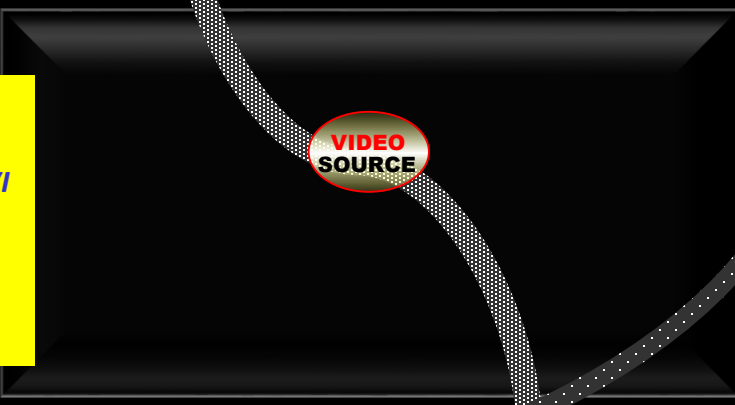

# Outlet ► Converter ► HDTV

## Combination Component (Y Pb Pr) & Phono Cable

Cable Outlet

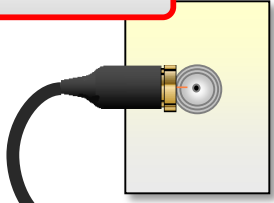

*This cable also comes with RCA-type audio jacks. Although these audio jacks will output STEREO sound, they are not capable of producing DOLBY 5.1 surround sound. For that, you must use a separate SPDIF audio connection, and have a receiver/TV that modulates surround sound.*

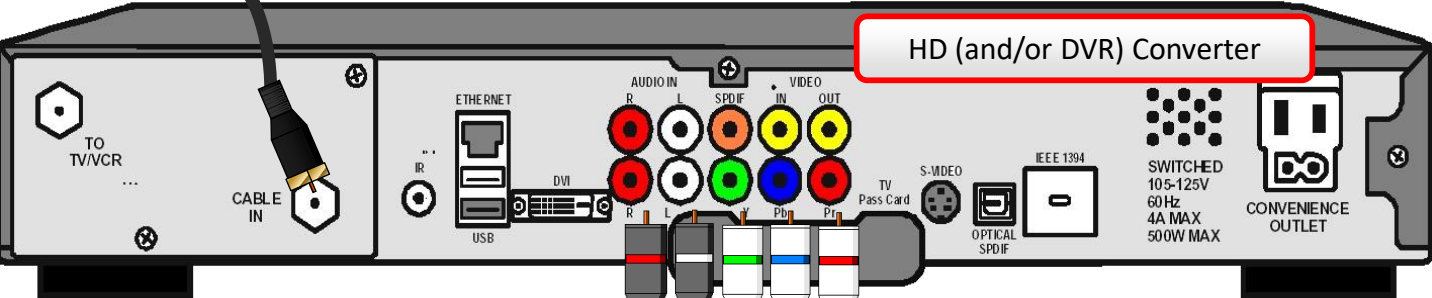

HDTV

With this configuration, the TV needs to be on its **COMPONENT INPUT CHANNEL** to receive the converter's Component signals.

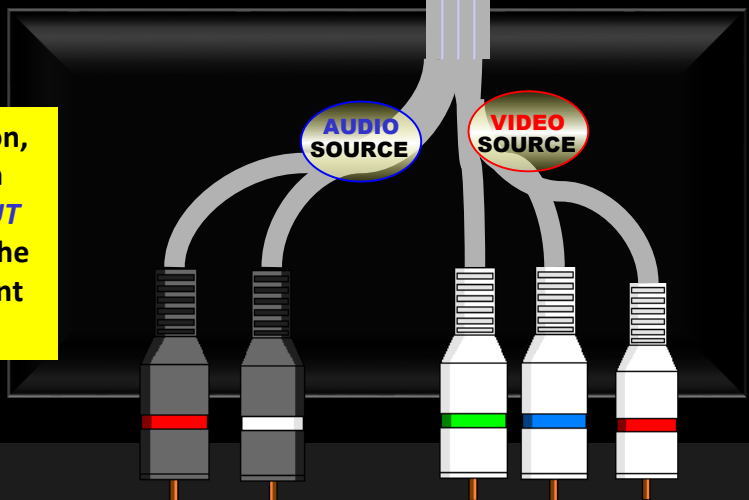

# Outlet ► Converter ► HDTV

Cable Outlet

## Combination Component (Y Pb Pr) & Phono Cable

*This cable also comes with RCA-type audio jacks. Although these audio jacks will output STEREO sound, they are not capable of producing DOLBY 5.1 surround sound. For that, you must use a separate SPDIF audio connection, and have a receiver/TV that modulates surround sound.*

HD (and/or DVR) Converter

HDTV

With this configuration, the TV needs to be on its **COMPONENT INPUT CHANNEL** to receive the converter's Component signals.

AUDIO SOURCE

VIDEO SOURCE



# Outlet ► Converter ► HDTV

- Component Cable (Y Pb Pr)
- Coaxial SPDIF cable (for Surround Sound)

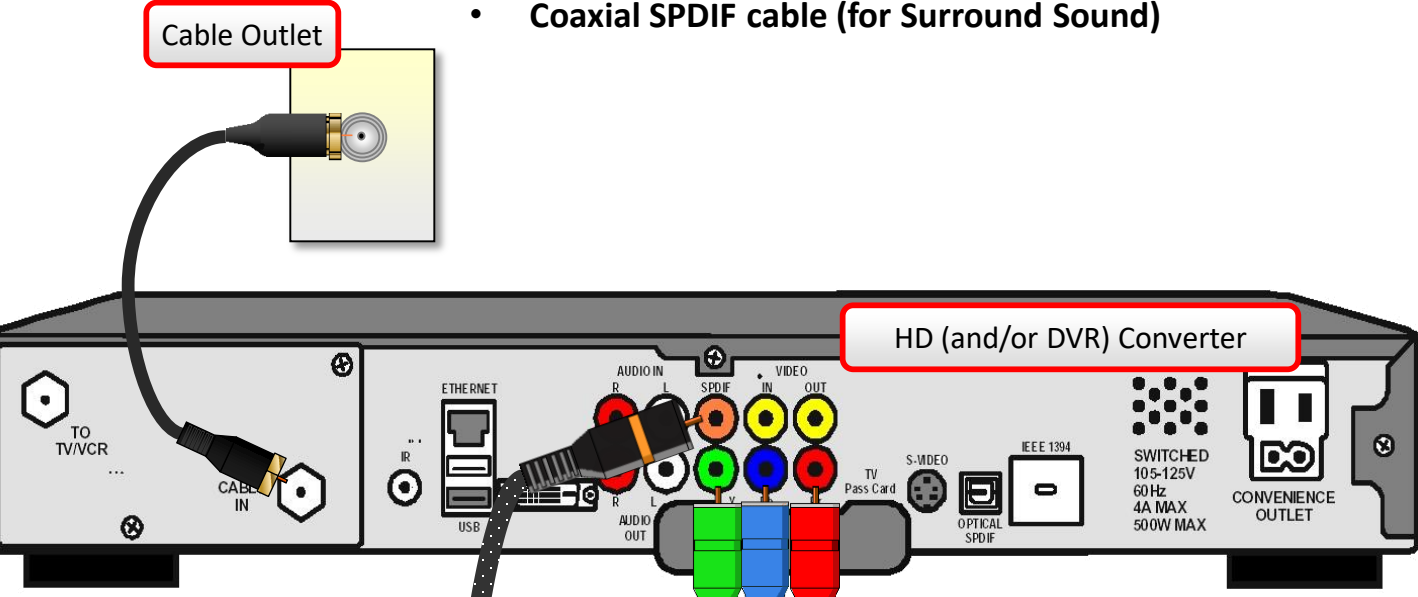

HDTV

AUDIO SOURCE

VIDEO SOURCE

With this configuration, the TV needs to be on its **COMPONENT INPUT CHANNEL** to receive the converter's Component signals.

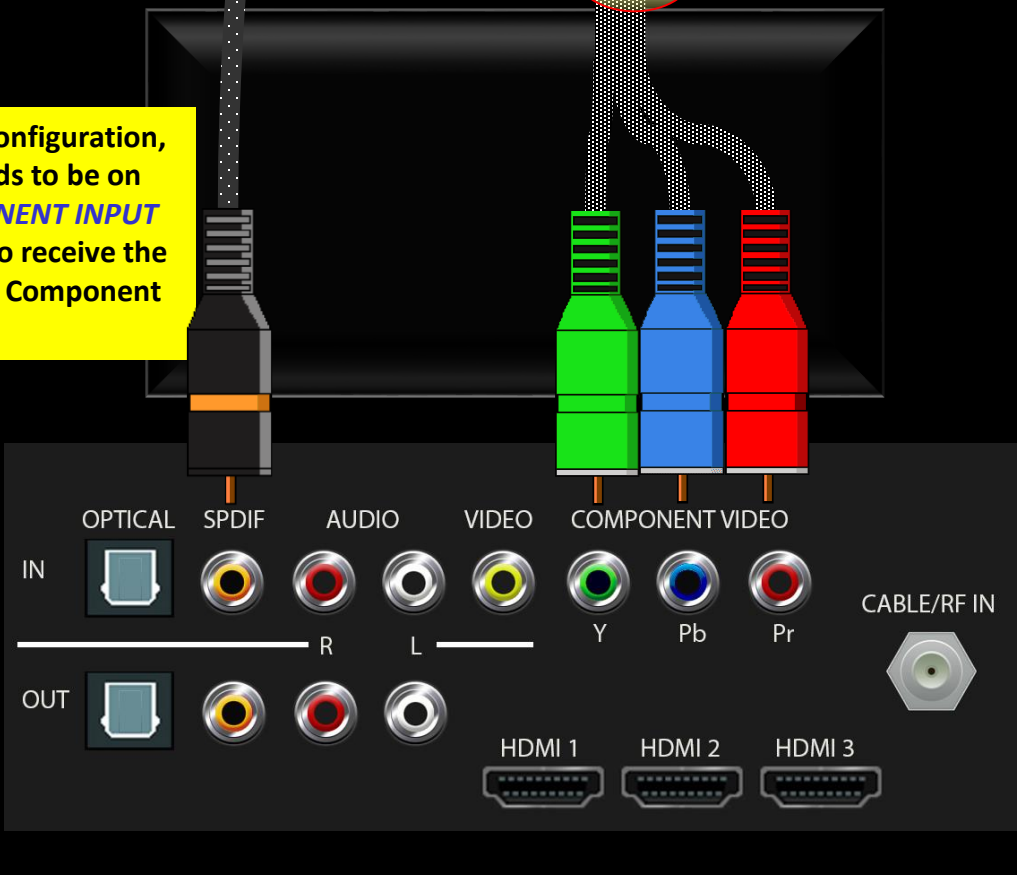



# Outlet ► Converter ► HDTV

- Component Cable (Y Pb Pr)
- Coaxial SPDIF cable (for Surround Sound)

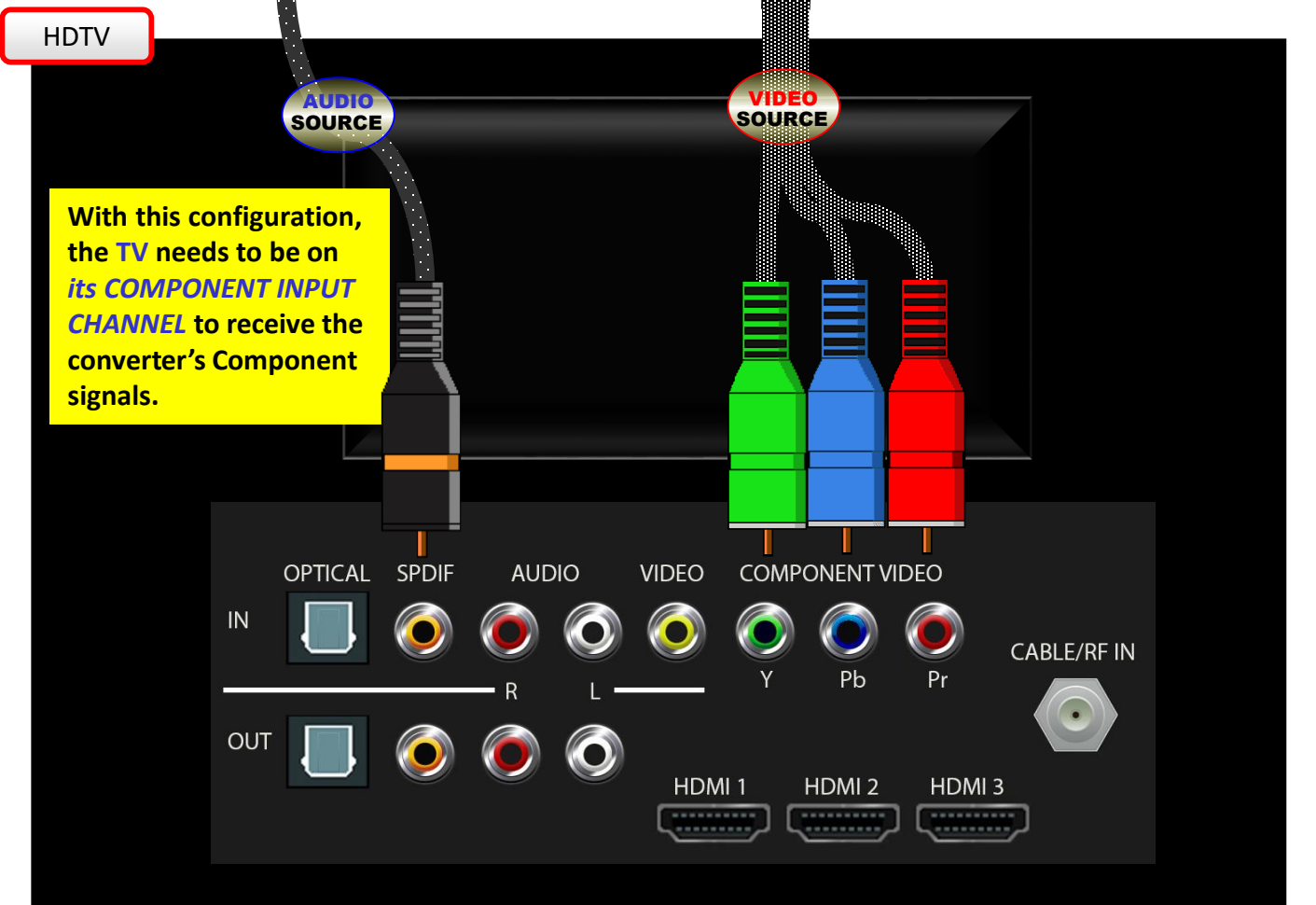
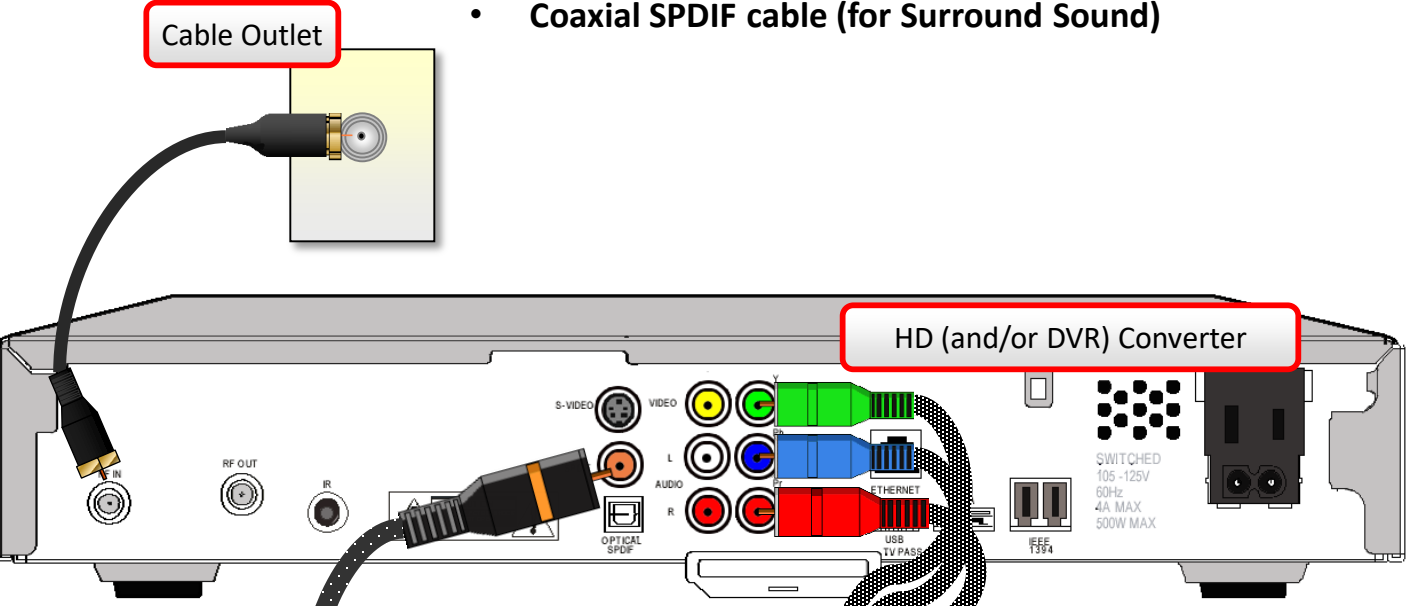

# Outlet ► Converter ► HDTV

- Component Cable (Y Pb Pr)
- Optical SPDIF cable (for Digital Surround Sound)

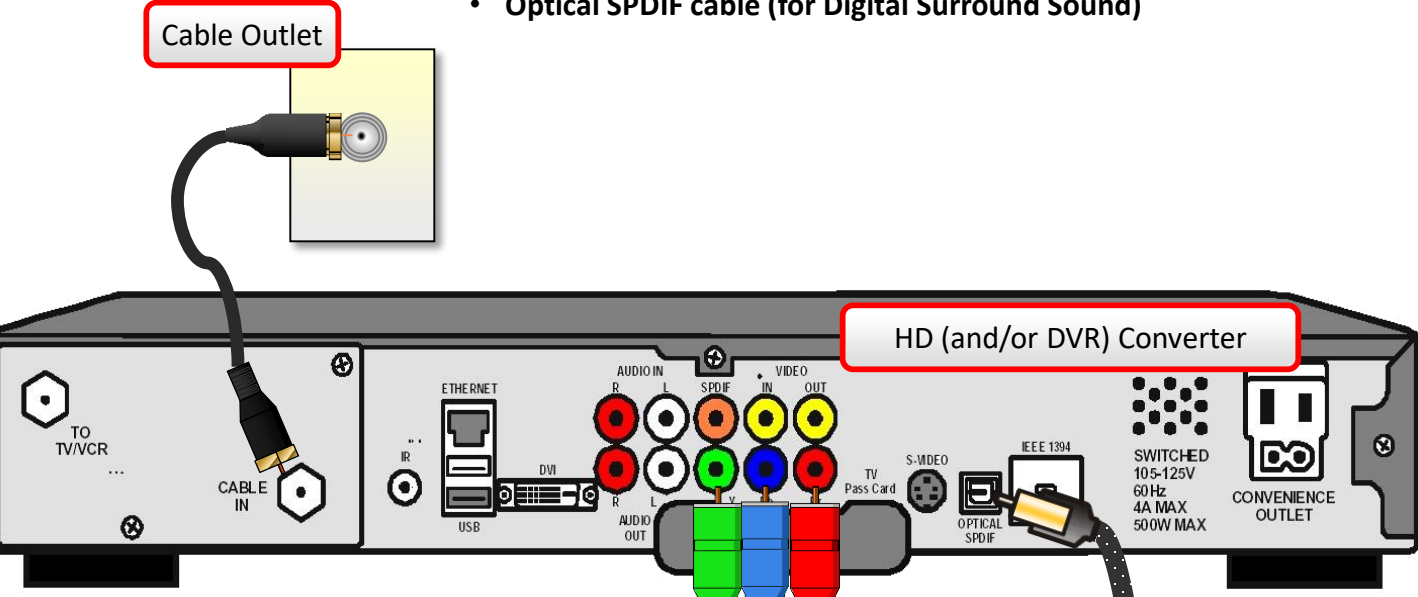

HDTV

VIDEO SOURCE

AUDIO SOURCE

With this configuration, the TV needs to be on its **COMPONENT INPUT CHANNEL** to receive the converter's Component signals.

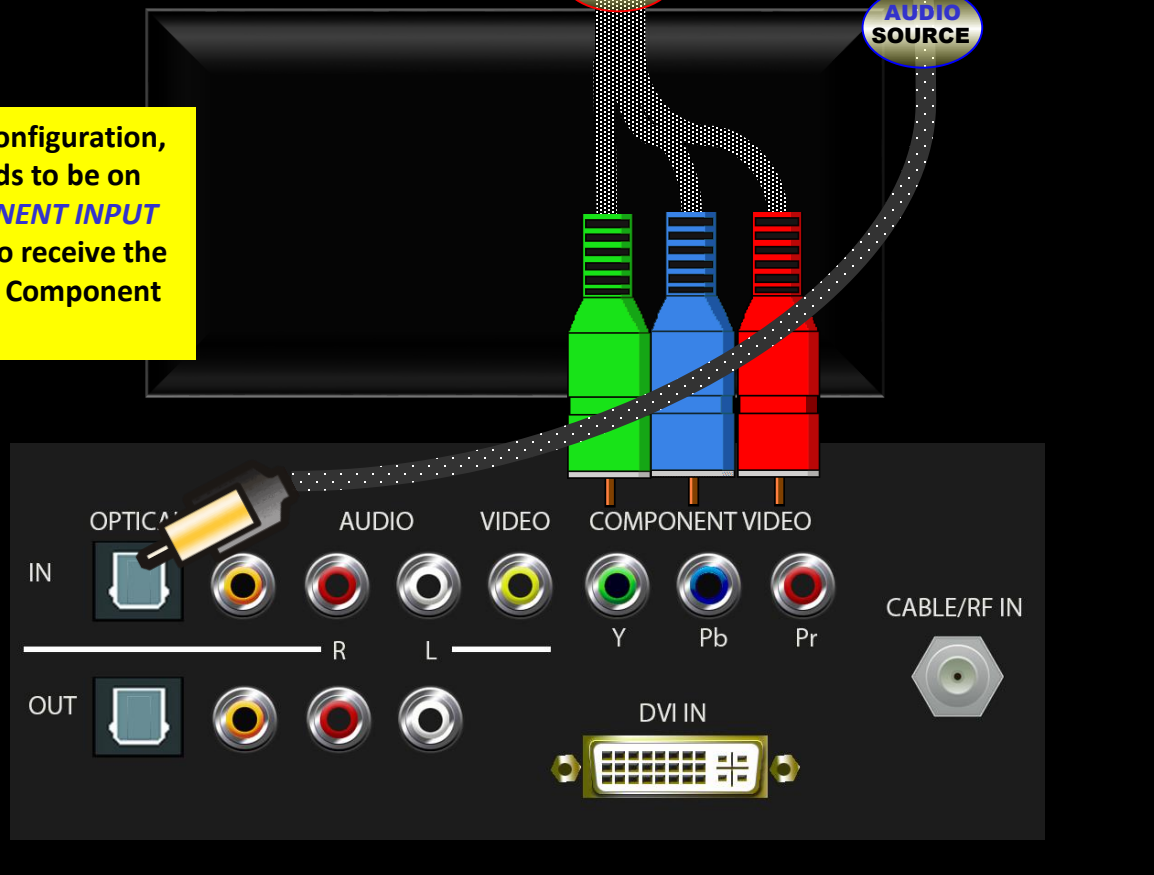

# Outlet ► Converter ► HDTV

- Component Cable (Y Pb Pr)
- Optical SPDIF cable (for Digital Surround Sound)

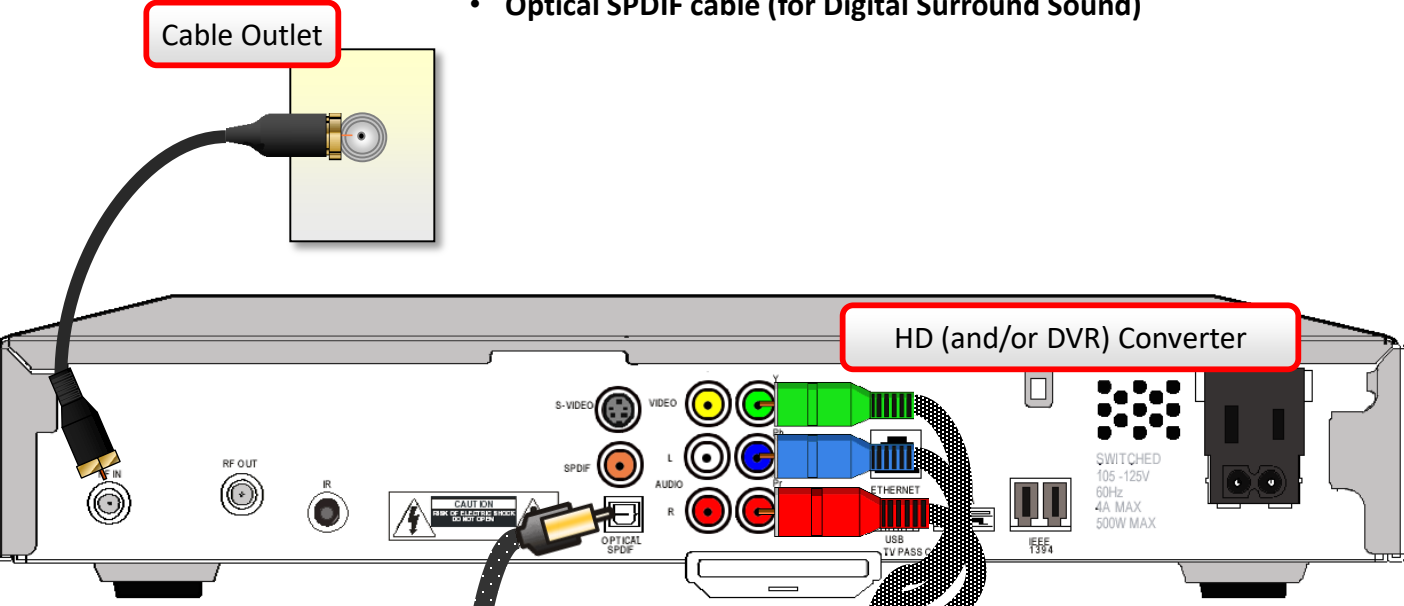

HDTV

With this configuration, the TV needs to be on its **COMPONENT INPUT CHANNEL** to receive the converter's Component signals.

